



# FIA EUROPEAN HISTORIC RALLY CHAMPIONSHIP

**37° Sanremo Rally Storico**  
**October 12<sup>th</sup> – 15<sup>th</sup>, 2022**

## SUPPLEMENTARY REGULATIONS

### INDEX

<b>1 INTRODUCTION .....</b>	<b>2</b>
<b>2 ORGANISATION.....</b>	<b>2</b>
<b>3 PROGRAMME .....</b>	<b>5</b>
<b>4 ENTRIES .....</b>	<b>7</b>
<b>5 INSURANCE.....</b>	<b>9</b>
<b>6 ADVERTISING &amp; IDENTIFICATION .....</b>	<b>10</b>
<b>7 TYRES.....</b>	<b>11</b>
<b>8 SERVICE AND FUEL .....</b>	<b>12</b>
<b>9 RECONNAISSANCE .....</b>	<b>13</b>
<b>10 ADMINISTRATIVE CHECKINGS.....</b>	<b>15</b>
<b>11 SCRUTINEERING, MARKING AND SEALING .....</b>	<b>15</b>
<b>12 OTHER PROCEDURES.....</b>	<b>17</b>
<b>13 IDENTIFICATION OF OFFICIALS.....</b>	<b>18</b>
<b>14 PRIZES .....</b>	<b>18</b>
<b>15 FINAL CHECKS AND PROTESTS .....</b>	<b>19</b>
<b>APPENDIX 1 – ITINERARY .....</b>	<b>20</b>
<b>APPENDIX 2 – RECONNAISSANCE SCHEDULE .....</b>	<b>22</b>
<b>APPENDIX 3 – COMPETITORS’ RELATIONS OFFICERS.....</b>	<b>23</b>
<b>APPENDIX 4 – COMPETITION NUMBERS AND ADVERTISING .....</b>	<b>24</b>
<b>APPENDIX 5 – CHAPTER III DRIVERS’ EQUIPMENT OF APPENDIX L.....</b>	<b>25</b>
<b>APPENDIX 6 – SAFETY TRACKING SYSTEM INSTRUCTIONS.....</b>	<b>26</b>
<b>APPENDIX 7 – FLAGS USED DURING THE RALLY .....</b>	<b>30</b>
<b>APPENDIX 8 – CARS OR CREWS NOT COMPLIANT TO FIA REGULATIONS .....</b>	<b>31</b>



## 1. INTRODUCTION

### 1.1 GENERAL

This rally will be run in compliance with the FIA International Sporting Code and its appendices, the 2022 FIA EHRC Sporting Regulations, the National Sporting Regulations which comply with the FIA regulations and these Supplementary Regulations.

Modifications, amendments and/or changes to these Supplementary Regulations will be announced only by numbered and dated Bulletins (issued by the organiser or the stewards)

The 2022 FIA EHRC Sporting Regulations can be found at: [www.fia.com/historic-regulations](http://www.fia.com/historic-regulations)

In the context of the COVID-19 pandemic, the primary responsibility sits with the event organiser to ensure that any national, regional or local laws, regulations, policy, guidance or advice issued by the competent authorities in the territories relevant to the event are complied with at all times

The COVID-19 protocol applied for the rally and relevant information can be found under the following URL:

<https://www.acisport.it/it/covid19>

### 1.2 ROAD SURFACE

Tarmac

### 1.3 OVERALL SS AND TOTAL DISTANCE OF THE RALLY

Total Special Stage Distance	142,53 Km
Total Rally Distance	373,10 Km
Number of Special Stages	11
Number of Sections	4
Number of Legs	2

## 2. ORGANISATION

### 2.1 TITLES FOR WHICH THE RALLY COUNTS:

#### FIA TITLES

FIA European Historic Rally Championship for Drivers and Co-Drivers– Category 1

FIA European Historic Rally Championship for Drivers and Co-Drivers – Category 2

FIA European Historic Rally Championship for Drivers and Co-Drivers – Category 3

FIA European Historic Rally Championship for Drivers and Co-Drivers – Category 4

FIA Trophy for EHRC Teams

#### Other titles:

ACI CIRAS – Campionato Italiano Rally Auto Storiche

### 2.2 VISA NUMBERS

FIA: **9EHRC/220824** issued on: **August, 24<sup>th</sup> 2022**

ASN: **AS130/2022** issued on: **August, 22<sup>nd</sup> 2022**



## 2.3 ORGANISER'S NAME / ADDRESS AND CONTACT DETAILS

Name: Automobile Club del Ponente Ligure  
Address: Via Tommaso Schiva, 11/19  
Tel: +39 3341662083  
E-mail: rallyesegreteria@ponenteligure.aci.it  
Web: <https://rallyesanremo.it>

## 2.4 ORGANISATION COMMITTEE

Chairman	Sergio Maiga
Member	Maria Luisa Paglieri
Member	Piersandro Boccone
Member	Alessandro Deveronico
Member	Giuseppe Fadini

## 2.5 STEWARDS

Chairperson (appointed by the FIA)	Henrik Frank (FIN)
FIA steward (appointed by the FIA)	Mirjana Simek Bilic (HRV)
ASN steward	Alessandro Degan - ASN License 217873
Secretary to the Stewards	Yvonne Gilli

## 2.6 FIA DELEGATES AND OBSERVER

FIA sporting delegate	Arnaud Crépin
FIA observer	Paavo Virtanen
FIA eligibility delegate	Pat O'Dowd
Assistant to FIA eligibility delegate	Elisabeth Van Der Plas
FIA media delegate	MacLean Communications – Sophie Liger

## 2.7 SENIOR OFFICIALS

Clerk of the Course	Simone Bettati	- ASN License 336067
Deputy Clerk of the Course	Alfredo Delleani	- ASN License 20758
Chief Safety Officer	Mattia Maiga	- ASN License 414924
ASN Safety Officer	Giuseppe Cerri Gambarelli	- ASN License 406223
Secretary of the Rally	Rosalba Tenci	- ASN License 31367
Assistant Secretary of the Rally	Cinzia Bosino	- ASN License 36271
Chief Medical Officer	Roberto Lucifredi	- ASN License 245346
Chief Scrutineer	Marco Berruti	- ASN License 202785
ASN Technical Delegate	Giuseppe Martorana	- ASN License 26907
2° ASN Technical Delegate	Giovanni Busotti	- ASN License 46668
Press Officer	Sergio Zaffiro	
Assistant Press Officer	Micol Maiga	
Chief of Results System	Massimo Rattalino	
Chief Timekeeper	Angelo Masin	
Competitors' Relations Officer	Franco Peirano	- ASN License 17400
Competitors' Relations Officer	Pietro Migliori	- ASN License 17100
Service Park Manager	Ferrante Federici	- ASN License 74636
GPS System Officer	Roberto Squaiella	



## 2.8 HQ LOCATION AND CONTACT DETAILS

Rally HQ location from Tuesday, October 11<sup>th</sup>, 2022 until Saturday, October 15<sup>th</sup>, 2022

Grand Hotel Londra  
Address: Corso Matuzia, 2 – 18038 Sanremo - IM  
Tel.: +39 334 1662083  
E-mail: rallyesegreteria@ponenteligure.aci.it  
GPS coordinates: 43°48'41.76"N, 7°45'49.46"E

### Rally HQ opening hours:

Tuesday, October 11 <sup>th</sup> , 2022	12:00 – 22:00
Wednesday, October 12 <sup>th</sup> , 2022	08:00 – 20:00
Thursday, October 13 <sup>th</sup> , 2022	08:00 – 20:00
Friday, October 14 <sup>th</sup> , 2022	07:30 – 20:00
Saturday, October 15 <sup>th</sup> , 2022	07:15 – 20:00

## 2.9 OFFICIAL NOTICE BOARD LOCATION

The ONB is located in Rally HQ, Corso Matuzia, 2 – 18038 Sanremo - IM

Virtual Notice Board (VNB) is online at <https://rallyesanremo.it> – Sportity App (downloadable for iOS devices on Apple Appstore and for Android devices on Google Play) - channel password: SRM22EHRC

## 2.10 LOCATION OF PARC FERMÉ

Former Railway Station

Date: Saturday, October 15<sup>th</sup>, 2022  
Location: Piazzale Adolfo Rava – Sanremo (IM)  
GPS coordinates: 43° 48' 16.89"N 7° 46' 16.92"E

## 2.11 LOCATION OF SERVICE PARK AND TRAILER PARK

Date: Thursday, October 13<sup>th</sup>, 2022, Friday, October 14<sup>th</sup>, 2022, Saturday, October 15<sup>th</sup>, 2022  
Location: Piazzale Adolfo Rava – Sanremo (IM)  
GPS coordinates: 43° 48' 16.89"N 7° 46' 16.92"E

### Opening hours:

Thursday, October 13 <sup>th</sup> , 2022	08:00 – 20:00
Friday, October 14 <sup>th</sup> , 2022	08:00 – 20:00
Saturday, October 15 <sup>th</sup> , 2022	07:15 – 18:00

## 2.12 MEDIA CENTRE OPENING HOURS

### 2.12.1. Media Centre

Location: Rally HQ  
GPS coordinates: 43°48'41.76"N, 7°45'49.46"E

### Opening hours:

Thursday, October 13 <sup>th</sup> , 2022	14:30 – 20:00
Friday, October 14 <sup>th</sup> , 2022	14:30 – 21:30
Saturday, October 15 <sup>th</sup> , 2022	07:30 – 22:00



### 2.13 MAIN GPS COORDINATES

Rally HQ and Media Centre	43° 48' 41.76"N 7° 45' 49.46"E
Ceremonial Start and Podium Finish	43° 48' 52.74"N 7° 46' 18.73"E
Pre-Event Scrutineering	43° 48' 16.89"N 7° 46' 16.92"E
Final Scrutineering	43° 51' 06.33"N 7° 50' 30.53"E
Start Shakedown Stage	43° 49' 52.04"N 7° 43' 11.70"E
Parc Fermé	43° 48' 16.89"N 7° 46' 16.92"E
Service Park	43° 48' 16.89"N 7° 46' 16.92"E

## 3. PROGRAMME

### 3.1 PROGRAMME BEFORE THE RALLY WEEK

<b>Tuesday, September 6<sup>th</sup>, 2022</b>		
08:00	Publishing of the Supplementary Regulations, entries open	<a href="https://rallyesanremo.it">https://rallyesanremo.it</a> <a href="mailto:iscrizioni@rallyesanremo.it">iscrizioni@rallyesanremo.it</a>
<b>Tuesday, September 27<sup>th</sup>, 2022</b>		
24:00	Closing date for entries	<a href="mailto:iscrizioni@rallyesanremo.it">iscrizioni@rallyesanremo.it</a>
<b>Saturday, October 1<sup>st</sup>, 2022</b>		
18:00	Original Entry Form must reach the Organiser	Permanent Secretariat
24:00	Closing date for order of extra services in Service Park, additional space, consecutive Service areas	<a href="mailto:iscrizioni@rallyesanremo.it">iscrizioni@rallyesanremo.it</a>
<b>Saturday, October 8<sup>th</sup>, 2022</b>		
20:00	Publication of Entry List	<a href="https://rallyesanremo.it">https://rallyesanremo.it</a>
<b>Monday, October 10<sup>th</sup>, 2022</b>		
24:00	Closing date for Media accreditation	<a href="https://rallyesanremo.it">https://rallyesanremo.it</a>

#### For Italian championship race only (Non FIA compliant cars or crews)

<b>Wednesday, October 5<sup>th</sup>, 2022</b>		
24:00	Closing date for entries	<a href="http://www.acisport.it/it/acisport">www.acisport.it/it/acisport</a>

### 3.2 PROGRAMME DURING THE RALLY WEEK

<b>Tuesday, October 11<sup>th</sup>, 2022</b>		
12:00 – 22:00	Rally HQ open	Rally HQ, Grand Hotel Londra, Sanremo
19:00 – 22:00	Registration for Reconnaissance Administrative Checkings Collection of Road Book, route map and other documents Collection of Rally Safety Tracker	Rally HQ, Grand Hotel Londra, Sanremo
<b>Wednesday, October 12<sup>th</sup>, 2022</b>		
08:00 – 20:00	Rally HQ open	Rally HQ, Grand Hotel Londra, Sanremo
08:00 – 20:00	Registration for Reconnaissance Administrative Checkings	Rally HQ, Grand Hotel Londra, Sanremo



	Collection of Road Book, route map and other documents Collection of Rally Safety Tracker	
08:00 – 20:00	Reconnaissance	See Schedule App 2
<b>Thursday, October 13<sup>th</sup>, 2022</b>		
08:00 – 20:00	Rally HQ open	Rally HQ, Grand Hotel Londra, Sanremo
08:00 – 13:30	Reconnaissance	See Schedule App 2
08:00 – 20:00	Service Park open Trailer Park open	Piazzale Adolfo Rava, Sanremo
10:00 – 17:00	Scrutineering - sealing and marking of components	Piazzale Adolfo Rava, Sanremo
14:30 – 20:00	Media Centre and Media Accreditation open	Media Centre, Rally HQ, Grand Hotel Londra, Sanremo
15:00 – 18:00	Optional Shakedown	San Romolo
19:00	First Stewards' Meeting	Rally HQ, Grand Hotel Londra, Sanremo
20:00	Publication of Start List For Leg 1	Official Notice Board, VNB
<b>Friday, October 14<sup>th</sup>, 2022</b>		
07:30 – 20:00	Rally HQ open	Rally HQ, Grand Hotel Londra, Sanremo
08:00 – 20:00	Service Park open Trailer Park open	Piazzale Adolfo Rava, Sanremo
08:30	Start Leg 1 / TC 0	Corso Imperatrice, Sanremo
14:30 – 21.30	Media Centre open	Media Centre, Rally HQ, Grand Hotel Londra, Sanremo
17:45	Finish Leg 1 / TC 6B	Piazzale Adolfo Rava, Sanremo
17:45	Parc Fermé	Parc Fermé, Piazzale Adolfo Rava, Sanremo
19:30	Publication of Start List for Leg 2	Official Notice Board, VNB
<b>Saturday, October 15<sup>th</sup>, 2022</b>		
7:15 – 8:00	Scrutineering of restarting cars	Parc Fermé, Piazzale Adolfo Rava, Sanremo
7:15 – 18:00	Service Park open Trailer Park open	Piazzale Adolfo Rava, Sanremo
7:15 – 18:00	Rally HQ open	Rally HQ, Grand Hotel Londra, Sanremo
7:30 – 22:00	Media Centre open	Media Centre, Rally HQ, Grand Hotel Londra, Sanremo
8:15	Start of Leg 2 / TC 6C	Parc Fermé, Piazzale Adolfo Rava, Sanremo
14:23	Finish Leg 2 / TC 11C	Piazzale Adolfo Rava, Sanremo



14:30	Podium Ceremony and Prize-Giving	Podium, Corso Imperatrice, Sanremo
14:45	Post-rally Press Conference	Podium, Corso Imperatrice, Sanremo
14:50	Parc Fermé after finish	Piazzale Adolfo Rava, Sanremo
15:00	Final Scrutineering	Gts – Centro Porsche, Regione Periane 18018, Arma di Taggia
16:30	Publication of Provisional Final Classification	Official Notice board, VNB

## 4. ENTRIES

### 4.1 CLOSING DATE FOR ENTRIES

**Tuesday, September 27<sup>th</sup>, 2022 – 24:00**

### 4.2 ENTRY PROCEDURE

**4.2.1** Anyone wishing to take part in the 37° Sanremo Rally Storicomust use the **FIA Online Registration Platform**.

All crews who wish to score points in the EHRC must make their entries by using the standard entry form for their championship available in the FIA application at: <https://registrations.fia.com/EHRC>

**4.2.2** Any other crews who are not registered in the EHRC and who are therefore not wishing to collect points in the EHRC, must use and send the entry form available at [https://registrations.fia.com/EHRC\\_9ITA](https://registrations.fia.com/EHRC_9ITA) duly completed before the closing date of entries.

Please note that the FIA registration platform requires a user ID and a password to access the entry system. Please do not wait until the last moment to make your entry in order not to miss the entry closing date.

### 4.2.3 Acceptance of Entry Form

The entry application will only be accepted if duly completed and accompanied by the bank transfer of the total amount of the entry fee to the Organiser's bank account.

### 4.3 NUMBER OF COMPETITORS ACCEPTED AND CLASSES

**4.3.1** The maximum number of entries accepted will be 80. If more than 80 entries are received, the Organiser reserves the sole right to decide which entries among the EHRCnon-registered drivers will be accepted.

### 4.3.2 Cars eligible to enter the event

Cars complying with FIA EHRC Sporting Regulations Art.12 are eligible.

#### 4.3.3 Classes of cars

CATEGORIES	CLASSES	
<b>Category 1</b>  Road legal cars built between 1/1/1931 and 31/12/1957 and Touring and GT cars, models homologated between 1/1/1958 and 31/12/1969.	<b>A1</b>	up to 1000cm <sup>3</sup> (before 31/12/1961)
	<b>A2</b>	from 1001cm <sup>3</sup> to 1600 cm <sup>3</sup> (before 31/12/1961)
	<b>A3</b>	over 1600cm <sup>3</sup> (before 31/12/1961)
	<b>B1</b>	up to 1000cm <sup>3</sup> (after 31/12/1961)
	<b>B2</b>	from 1001cm <sup>3</sup> to 1300cm <sup>3</sup> (after 31/12/1961)
	<b>B3</b>	from 1301cm <sup>3</sup> to 1600cm <sup>3</sup> (after 31/12/1961)
	<b>B4</b>	from 1601cm <sup>3</sup> to 2000cm <sup>3</sup> (after 31/12/1961)
	<b>B5</b>	over 2000cm <sup>3</sup> (after 31/12/1961)
<b>Category 2</b>  Touring (T), Competition Touring (CT), Grand Touring (GT) and Competition Grand Touring (GTS) cars of Groups 1, 2, 3 and 4, models homologated between 1/1/1970 and 31/12/1975.	<b>C0</b>	up to 1150cm <sup>3</sup>
	<b>C1</b>	from 1151cm <sup>3</sup> to 1300cm <sup>3</sup>
	<b>C2</b>	from 1301 cm <sup>3</sup> to 1600cm <sup>3</sup>
	<b>C3</b>	from 1601 cm <sup>3</sup> to 2000cm <sup>3</sup>
	<b>C4</b>	over 2000cm <sup>3</sup>
<b>Category 3</b>  Touring (T), Competition Touring (CT), Grand Touring (GT) and Competition Grand Touring (GTS) cars of Groups 1, 2, 3 and 4, models homologated between 1/1/1976 and 31/12/1981.	<b>D0</b>	up to 1150cm <sup>3</sup>
	<b>D1</b>	from 1151cm <sup>3</sup> to 1300cm <sup>3</sup>
	<b>D2</b>	from 1301cm <sup>3</sup> to 1600cm <sup>3</sup>
	<b>D3</b>	from 1601cm <sup>3</sup> to 2000cm <sup>3</sup>
	<b>D4</b>	over 2000cm <sup>3</sup>
<b>Category 4</b>  Touring (T), Competition Touring (CT), Grand Touring (GT) and Competition Grand Touring (GTS) cars of Groups A, B and N, models homologated between 1/1/1982 and 31/12/1985 (Period J1) and models homologated between 1/1/1986 and 31/12/1990 (Period J2).	<b>E1</b>	Group A up to 1300cm <sup>3</sup>
	<b>E2</b>	Group A from 1301cm <sup>3</sup> to 1600cm <sup>3</sup>
	<b>E3</b>	Group A from 1601cm <sup>3</sup> to 2000cm <sup>3</sup>
	<b>E4</b>	Group A over 2000cm <sup>3</sup>
	<b>E5</b>	Group B up to 1600cm <sup>3</sup>
	<b>E6</b>	Group B over 1600cm <sup>3</sup>
	<b>E7</b>	Group N up to 1600cm <sup>3</sup>
	<b>E8</b>	Group N over 1600cm <sup>3</sup>

#### 4.4 ENTRY FEES

The entry fees for the Competition are fixed, per car, at:

<b>Under 1.300cm<sup>3</sup>:</b>	<b>€ 780,00 + VAT</b>
<b>Between 1.301cm<sup>3</sup> and 2.000cm<sup>3</sup>:</b>	<b>€ 870,00 + VAT</b>
<b>Over 2.000cm<sup>3</sup>:</b>	<b>€ 970,00 + VAT</b>

**Optional Shakedown: € 150,00 + VAT**





All above mentioned fees does not include **Rally Safety Tracker system tax:€ 78,00 + VAT**

#### 4.4.1 Entry packages

The entry fee includes:

Package	Private competitor	Legal entity as competitor (x 1 Car)
<b>Vehicle Plates</b>		
Recce Plates	1	1
Service	1	1
Service Park	1	1
<b>Passes (Bracelets)</b>		
Driver	2	2
Team	4	6
<b>Administration</b>		
Route Maps	1	1
Road book sets	1	1
<b>Services</b>		
Areas in Service Park	8x10 meters	10x10 meters

#### 4.5 PAYMENT DETAILS

The entry fee must be paid by bank transfer to organizer's bank account:

Bank: **BANCA CARIGE DI IMPERIA – FILIALE 1736**  
Account Holder: **AUTOMOBILE CLUB DEL PONENTE LIGURE**  
IBAN: **IT84H061751050000002505080**  
SWIFT/BIC Code: **CRGEITGG**

#### 4.6 REFUNDS

Entry fees will be refunded in full:

- To entrants whose entry has not been accepted.
- In case of the rally not taking place.

### 5. INSURANCE

The organiser provides the following insurance:

#### 5.1 Introductory remarks

The entry fee includes the insurance premium for the competitors' civil liability to third parties for risks arising from circulation during the rally, along the route (fixed route and/or alternative) described in the Road book or given out by Bulletins and Clerk of the Course Communications.

#### 5.2 Damages covered by the insurance

The Insurance Policy of the Rally organiser is covering only the damages caused to third parties or properties of third parties by the Rally organiser or by drivers entered in the rally. Any other damage suffered by the drivers or vehicles entered in the rally are not covered by the insurance.



### **5.3 Rally organisers' responsibility**

The Rally organiser decline liability for any accident suffered by competitors or competing cars during the duration of the entire event, even in case of cataclysm, riots, demonstrations, vandalism, etc. Competitors and crew members shall suffer all the consequences (material, criminal and sporting) raised by any type of accident.

### **5.4 Insurance coverage**

The maximum amount covered by the Insurance Policy is € 25,000,000.00 for each accident for damages to persons and for damages to goods.

### **5.5 Duration of the insurance coverage**

This insurance, for all competitors, will become effective at the start of procedure for car scrutineering. The insurance ceases at the end of the event (Prize giving Ceremony-Podium) or at the end of the post-event scrutineering (for the selected cars), in case of withdrawal, disqualification or exclusion from the rally.

In case of withdrawal, the time taken into account will be the closing time of the following TC.

Cars having retired and restarting the next day shall not be considered to have permanently retired.

### **5.6 Assistance or service vehicles**

Vehicles carrying "Service", "Service Park" or "Auxiliary" plates and/or any other plate issued by the Rally organiser, with the exclusion of Rally organisers' Safety and Zero cars and cars used by Officials and Delegates are not covered by the event's Insurance policy. These vehicles circulate under their owners' responsibility and shall have their own insurance.

### **5.7 Insurance during reconnaissance**

Vehicles used by the crews during reconnaissance, even if bearing the event's specific stickers, must be insured by their owners. The Rally organiser bear no responsibility for such vehicles. This same rule applies to the drivers taking part in reconnaissance only.

### **5.8 Accident notification**

In case of an accident the competitor or his representative must immediately notify it to the Clerk of the course. Place, circumstances under which the accident occurred, causes and consequences must be described. Likewise the names and addresses of any witness or injured person must be indicated.

## **6. ADVERTISING & IDENTIFICATION**

Advertising restrictions: Tobacco or tobacco products', alcohol, betting and gambling advertising is prohibited in Italy. This law applies to competing and service cars, equipment and clothing.



## 7. TYRES

### 7.1 NUMBER OF TYRES & TYRE MARKING PROCEDURE

#### 7.1.1 Eligible tyres

All tyres used for rally stages on tarmac and road sections must be marked «E» or «DOT» in accordance with the appropriate standard of the country in which the Competition is taking place. They must have a minimum external diameter corresponding to the period in question (see Article 8.4.2 of Appendix K) and they must not be marked «*Not for highway use*» nor «*For Racing Only*» nor imply any indication limiting, specifying or recommending a use in competition. Any alteration, modification or adaptation (which for the avoidance of doubt includes cutting of additional grooves) of tyres other than wear through normal use is forbidden. For stages run on gravel, and so declared by the clerk of the course, no «E» or «DOT» tyre marking is necessary.

a) Cars of Category 1: During Competitions classed as tarmac event (i.e. excluding gravel or snow Competitions) there shall be **a maximum of 14 tyres permitted**. Tyres must be uniquely identified with a barcode (or such other method as may be prescribed) and registered with the FIA eligibility delegate before the start of the Competition.

Checks for compliance with this regulation may be undertaken at any time during the Competition and any discrepancies will be reported to the stewards. A detailed information sheet will be available before each Competition.

b) Cars of Category 2, 3 and 4: During Competitions classed as tarmac (i.e. excluding gravel or snow Competitions) there shall be **a maximum of 10 tyres said «dry» permitted**. Tyres must be uniquely identified with a barcode (or such other method as may be prescribed) and registered with the FIA eligibility delegate before the start of the Competition.

Due to the lack of availability of «wet» tyres in their appropriate sizes, the cars listed as exceptions in the appendix to the FIA authorized wet tyre list may register a maximum of 14 tyres before the start of the Competition. Thus there is no allowance for additional «wet» tyres.

Checks for compliance with this regulations may be undertaken at any time during the Competition and any discrepancies will be reported to the stewards. The number of «wet» tyres is not limited. Only the «wet» tyres as per the FIA authorised tyre list can be used. A detailed information sheet will be available before each Competition.

**7.1.2 Tyre marking** is obligatory for all the competitors.

All tyres must have a specific barcode number supplied by the 2022 FIA-approved barcode supplier. All tyres must be registered with the FIA Eligibility delegate before the start of the rally, at pre-event scrutineering.

The cars must be presented at the tyre Marking Zone with their spare wheels placed with the outer part of the rim on top, and if needed, unfastened, to facilitate the procedure. Following the marking, and before the cars departure from the tyre marking area, crews, or their team member, must properly fasten the spare wheels as required.

For Competitors taking part in the Shakedown, tyres used for the Shakedown will not be marked.

#### 7.1.3 Tyre Marking during the rally

A wheel/tyre marking / barcode reading zone may be established at the exit of the authorised service parks or remote service zones and at the start of a stage.



The crew has to stop its car and wait for the instructions of the scrutineers and/or marshal. In the absence of scrutineers or marshals, the crew may leave the zone without stopping. A tyre mark checking zone may be established at the entrance of the authorised service parks and remote service zones.

#### **7.1.4 Means of control**

Checks for compliance with this regulation may be undertaken at any time during the rally and any discrepancies will be reported to the stewards. A detailed information sheet will be available before each rally.

### **7.2 TYRES USED FOR RECONNAISSANCE**

Only E- or DOT-approved homologated road legal tyres are allowed. Retreaded tyres are forbidden for reconnaissance. Any treatment (ie. removing or damaging) on road tyres side markings or texts is not allowed.

### **7.3 NATIONAL LAWS OR SPECIAL REQUIREMENTS**

**7.3.1** The use of studded tyres is not allowed.

## **8. SERVICE AND FUEL**

### **8.1 SERVICE – GENERAL CONDITIONS**

All services made on the car for the duration of the rally must be made in accordance with the EHRC Sporting Regulations, Article 56.

### **8.2 PERMITTED SERVICE LOCATIONS**

#### **8.2.1 Service Park**

The Service Park is situated at Piazzale Adolfo Rava - Sanremo and will be open to the Competitors

**Thursday, October 13<sup>th</sup>, 2022 08:00 – 20:00**

**Friday, October 14<sup>th</sup>, 2022 08:00 – 20:00**

**Saturday, October 15<sup>th</sup>, 2022 07:15 – 18:00**

GPS coordinates: **43° 48' 16.89"N 7° 46' 16.92"E**

#### **8.2.2 Additional Service Zones**

Servicing will also be permitted in Remote Service Zones in accordance with EHRC Sporting Regulations Article 60, at the following locations:

Leg 1 - Sections 1 and 2: Via Piano della Fiera - Molini di Triora (IM) - 43° 59' 13.83"N 7° 46' 35.48"E

Leg 2 - Sections 3 and 4: Bajardo (IM) - 43° 54' 12.97"N 7° 43' 14.89"E

#### **8.2.3 Procedure in Remote Service Zones**

**Molini di Triora:** Competitor cars' entrance and exit will be regulated by TCs as per attached itinerary; no service trucks are allowed inside RSZ, only one small van or car for each competitor's car, with



“Service” plate glued to windscreen, will be allowed. Service vehicles will have to leave Service Zone no later than 10’ after their competitor’s car.

**Bajardo:** Competitor cars’ entrance and exit will not be regulated by TCs; no service trucks are allowed inside RSZ, only one small van or car for each competitor’s car, with “Service” plate glued to windscreen, will be allowed. Service vehicles will have to leave Service Zone no later than 10’ after their competitor’s car.

### 8.3 FUEL RESTRICTIONS

It is mandatory for participants to use Fuel in accordance with FIA Appendix K Article 3.9.

### 8.4 REFUELLING

#### 8.4.1 All Competitors may only refuel in a Refuelling Zone (RZ) as indicated in the Road Book.

Competitors’ cars may be refuelled from drums/cans with commercially available fuel and two team members with team passes may access the RZ to assist each crew. In order to access the refuelling zone, team personnel must wear clothing that provides adequate protection against fire and includes at least: long trousers, long-sleeved top, closed shoes, a balaclava and gloves.

Refuelling during the rally must be done in RZ Only

Organiser will provide environmental mat/ground protection for refuelling

#### 8.4.2 Refuelling in a commercial filling station

In Molini RZ there is a commercial filling station, open 24/7 in self service

#### 8.4.3 Refuelling procedure

The completerefuelling procedure must be in compliance with Article 61.2 of the FIA EHRC Sporting Regulations.

**During the refuelling, the crew must remain outside the car**

## 9. RECONNAISSANCE

### 9.1 PROCEDURE FOR REGISTRATION

**Reconnaissance registration will take place as follows:**

Date:	Tuesday, October 11 <sup>th</sup>	19:00 – 22:00
	Wednesday, October 12 <sup>th</sup>	08:00 – 20:00
Location:	Rally HQ	Grand Hotel Londra - Sanremo

Reconnaissance material will be issued upon collection of the Road Book.

#### 9.1.1 Registration form

Reconnaissance registration will be done at collection of the Road Book

#### 9.1.2 Checking of Reconnaissance cars

Reconnaissance cars must comply with Art.35.1 of FIA EHRC Sporting Regulations.

If, for any reason, a crew is forced to replace the reconnaissance car during the reconnaissance, the Secretariat (phone: +39 334 1662083) must be informed about the details of the new reconnaissance car. Failure to follow this procedure will result in refusal to participate in the reconnaissance.



### **9.1.3 Reconnaissance identification**

The crew will receive identification for their car (2 number stickers). The number stickers must be fixed to the top right of the front windscreen and rear right side window during reconnaissance at all the times.

Each crew will be issued with a reconnaissance card valid for the passages through each Special Stage. The card will be given to Competitors after checking of the recce car. This card must be carried in the reconnaissance vehicle (accompanied by a personal ID document) and must be shown during reconnaissance to Organisers and police. Failure to hand in this card will result in refusal to participate in the reconnaissance.

## **9.2 RALLY-SAFETY-TRACKING-SYSTEM**

not used during Reconnaissance

### **9.2.1 Safety tracking deposit**

NA

## **9.3 RECONNAISSANCE TIME SCHEDULE**

Reconnaissance Time Schedule is given in Appendix 2.

## **9.4 RECONNAISSANCE RULES**

The crews are obliged to follow all reconnaissance rules specified in FIA EHRC Sporting Regulations and these Supplementary Regulations.

### **9.4.1 Reconnaissance**

Reconnaissance will be organised in compliance with art. 35 of FIA EHRC Sporting Regulations and only series production cars conforming to art. 35.1 of FIA EHRC Sporting Regulations must be used.

### **9.4.2 Speed limit (Art. 34.2 of FIA EHRC Sporting Regulations):**

The maximum speed set for the reconnaissance of the SS is 50 km/h, except for those areas in which there are speed limit signs or in built-up areas (30 km/h) or other limitations marked in the Road Book.

### **9.4.3 Direction**

Each crew may drive the Special Stages only in the direction of the rally. The crews must always enter and leave the Special Stages through the start and stop controls.

### **9.4.4 Restriction of reconnaissance**

Any driver, or his co-driver, or any other team member who has entered or intends to enter the rally and who wishes to drive 3 months ahead the rally on any road which is or might be used as a Special Stage in that rally, may only do so after he has obtained written permission from clerk of the course. Failure to respect this rule shall result in the driver being reported to the stewards.

### **9.4.5 Number of persons on board**

During each passage through a Special Stage, a maximum of 2 persons (the crew) are permitted in the car.

### **9.4.6 Number of passages**



3 passages are permitted for each stage, Special Stages run twice are considered to be one special stage; SS11 is considered to be one special stage with SS8 and SS9.

#### 9.4.7 Illegal reconnaissance

Illegal reconnaissance performed out of the official time schedule or performing more passages than permitted will be reported to the stewards.

#### 9.4.8 Speeding

Speeding will be penalized according to the Art. 34.2 of FIA EHRC Sporting Regulations.

Speeding during reconnaissance will incur a fine applied by the clerk of the course as follows - per km per hour over the speed limit: **all Drivers €25.**

The fine will be doubled in case of a second offence committed during reconnaissance.

#### 9.4.9 Radar detection equipment

The fitting or carrying of radar detection equipment during reconnaissance is not permitted.

Infringements will be reported to the stewards.

## 10. ADMINISTRATIVE CHECKINGS

### 10.1 DOCUMENTS TO BE PRESENTED

At Administrative Checkings the following documents will be checked and entry form details verified:

- Competitor's licence
- Driver and Co-driver competition licences
- Driver and Co-driver valid driving licence
- ASN authorisation (mandatory for all foreign Competitors and/or Drivers)
- Completion of all details on the entry form
- Valid personal accident insurance of non-EU Drivers
- Car registration papers
- Valid car's HTP

### 10.2 TIMETABLE

**Administrative Checkings will take place as follows:**

Date:	Tuesday, October 11 <sup>th</sup>	19:00 – 22:00
	Wednesday, October 12 <sup>th</sup>	08:00 – 20:00
Location:	Rally HQ	Grand Hotel Londra - Sanremo

All Administrative Checkings must be completed by 20:00 on Wednesday, October 12<sup>th</sup> at Rally HQ. Drivers and Co-drivers must be present at Administrative Checkings.

## 11. SCRUTINEERING, SEALING AND MARKING

### 11.1 SCRUTINEERING VENUE AND TIMETABLE

Venue:	Piazzale Adolfo Rava	Sanremo
Date:	Thursday, October 13 <sup>th</sup>	10:00 – 17:00



**The detailed timetable for pre-rally scrutineering will be published in a Bulletin.**

Any crew taking part in the rally, or their representative must arrive at the Scrutineering and present the car in accordance with the timetable to be issued in a Bulletin. **Any lateness entering to pre-rally Scrutineering area will be sanctioned with a fine of €30 for each 10 minutes delayed.** Drivers and Co-drivers are not required to attend Scrutineering.

The cars must be fully prepared and ready for all necessary sealing and marking (Art 16.1.2 FIA EHRC Sporting Regulations), (if the car is not prepared for the sealing, the car will not be authorized to access to the Scrutineering and fine for lateness will be applicable):

- compressor (turbocharger) and the spare one for all compressor equipped cars;
- The dismantled underbody protectors must be kept with the car weight checks.  
Sealing wires must be installed according to the instructions given at a later date.

#### **Documents to be presented at scrutineering:**

- Vehicle registration document, when it's applicable;
- power of attorney or letter of permission from the owner of the car, if he/she is not one of the Drivers;
- Valid vehicle insurance policy (e.g. Green Card);
- **Vehicle original FIA HTP.** In addition, homologation form for rollcage (if homologated) must be with the car at Scrutineering.

The crew must present the FIA HTP to the FIA eligibility delegate who will keep it until the end of the event. If this is not submitted, the car may not start.

#### **11.2 CREW MEMBERS' SAFETY EQUIPMENT**

At Scrutineering Competitors must produce all items of protective clothing, underwear, including helmets and a FIA approved head restraint (FHR, formerly called HANS) intended to be used.

Compliance with Appendix L Chapter III will be checked. The use of FHR in Category 1 is recommended but not mandatory. Any infringement will be penalised by the stewards.

The use of driver's safety equipment may be checked at any time.

#### **11.5 INSTALLATION OF SAFETY TRACKING SYSTEM**

All competitors must arrange their rally car(s) for the mounting of R.D.S. Tracking System Rally Box. The tracker will be given to crews at administrative checkings. The correct mounting and functioning of the equipment will be checked at pre-event scrutineering.

The safety tracking equipment will be collected at the last TC or in the final Parc Fermé where the cars must be left open for this purpose. In case of retirement the equipment must be returned to R.D.S. workshop in SP or Rally HQ no later than 30 minutes after the publication of the final classification.

For further information see **Appendix 6 to this SR**





## 12. OTHER PROCEDURES

### 12.1 CEREMONIAL START PROCEDURE

#### Ceremonial Start procedure

Not present, Rally will start at TCO, where crews must queue, following start list, **10 minutes before their individual starting time**

### 12.2 FINISH PROCEDURE

**TC14A** is the final TC of the rally from where competing cars will be driven by their Crews, under Parc Fermé rules, to the Podium Ceremony and then to the final Parc Fermé.

Competing cars subject to final scrutineering at GTS Centro Porsche – Regione Peirane, 18018 Arma di Taggia will remain in the venue of scrutineering, under Parc Fermé rules, until they are released.

### 12.3 PERMITTED EARLY CHECK-IN

Crews are authorised to check-in early without time penalty at:

**TC 6A – TC6B**

### 12.4 START PROCEDURE AND ORDER

#### 12.4.1 Starting order and intervals

The start order will according to Article 41 of the FIA EHRC Sporting Regulations.

The interval between each car will be 1 minute.

#### 12.4.2 Start procedure for Special Stages

Start Procedure for Special Stages will be as follows:

Start of the Special Stages will be in accordance to Art.48.1 of EHRC Sporting Regulations.

The start marshal will count down aloud: 30, 15 and 10 seconds to start and will indicate electronic start device to the crew.

The electronic start procedure, clearly visible to the crew from the start line, will be as follows:

- Red light: 10 second to start
- Yellow light: 5 seconds to start
- 5, 4, 3, 2, 1 seconds to start by countdown
- Green light: start sign.

Green Light will remain turned on for 20 seconds.

In event of having to use a manual start procedure the start marshal will countdown also last five seconds one by one. When the last 5 seconds have elapsed, start sign will be given to the crew

Jump start photocell will be placed 50cm after the start line

#### 12.4.3 Re-start after retirement / Catch-up

Re-start will be allowed under all provisions applied in Article 54 of FIA EHRC Sporting Regulations.

Any crew which has failed to complete Leg 1 can re-start the rally from the start of Leg 2 unless if they confirm otherwise to the Clerk of the Course prior to the publication of the start list of Leg 2 on Friday, October 14<sup>th</sup> 2022, 19:30.



The restarting car must report to the overnight Parc Fermé prior to Leg 2, on Saturday, October 15<sup>th</sup> 2022, 6:45. The re-scrutineering will take place at 7:15.

## 12.5 REMOVAL OF CARS FROM THE FINAL PARC FERMÉ

Cars may be removed from final Parc Fermé once the stewards authorise its opening. Provided that the above takes place as scheduled, all cars must be removed no later than 60 minutes after posting time of final classification on Saturday, October 15<sup>th</sup> 2022.

## 12.6 OFFICIAL TIME USED DURING THE RALLY

Throughout the rally, the official time will be **UTC**, Time zone of Italy in October is CEST (UTC + 2)

## 12.7 TIME CARDS

**12.7.1.** New time cards will be issued to the Competitors at the following time controls:

**TC 3A – TC6C – TC9A – TC11B**

**12.7.2.** Upon retiring, a crew must hand in its time card either to a marshal at a time Control or to the sweeping car.

## 12.8 – ADDITIONAL PROVISIONS BY THE ORGANISER IN THE CONTEXT OF COVID-19

*ACI Sport COVID 19 protocol will be applied for the entire event; updated version can be found at: <https://www.acisport.it/it/covid19>*

## 13. IDENTIFICATION OF OFFICIALS AND MEDIA

Official function with text on tabard	Colour of the identification tabard
Stage Commander	Red with text
Stage Safety Officer	Orange
Safety Marshal	Yellow/green with marking
Competitors' Relations Officer	Red with text
Scrutineer	Black
Media	Purple
Radio Point Marshal	Yellow/green with marking
Judges of fact	Yellow/green

## 14. PRIZES

### 14.1 PRIZE-GIVING

Date: Saturday, October 15<sup>th</sup> 2022, 14:30

Location: FinalPodium, Corso Imperatrice, Sanremo

Prizes will be awarded according to the final results of the Rally.

The following cups will be awarded as a minimum to both Driver and Co-driver:

- Winners in each category.



- Winners in each class.

Where there are three or more classified in either category or class, awards for 2nd place will be given.

Where there are six or more classified in either category or class, awards for 3rd place will be given.

## 15. FINAL CHECKS AND PROTESTS

### 15.1 Final Scrutineering

Date: Saturday, October 15<sup>th</sup> 2022, 15:00

Location: GTS – Centro Porsche, Regione Peirane 18018, Arma di Taggia

Competitors who will be selected for final Scrutineering are requested to provide proper equipment (including all sealed spare parts) and mechanics at the Final Scrutineering venue.

Each selected car will be driven to Final Scrutineering by a designated member of the team (who must be present at the finish) and accompanied by an official.

In case of a protest, the said car will be checked at the same venue.

### 15.2 PROTEST DEPOSIT

The protest deposit is €1,000.00 (FIA EHRC Sporting Regulations - Art. 65.2).

If a protest requires the dismantling and re-assembly of different parts of the car, the claimant must pay an additional deposit:

**15.2.1** For a protest involving only a clearly defined part of the car (engine, transmission, steering, braking system, electrical installation, body work, etc.): additional deposit € to be defined by panel of Steward

**15.2.2** For a protest involving the whole car: additional deposit € to be defined by panel of Steward

### 15.3 APPEAL DEPOSIT

The sum for an international appeal deposit (FIA) is: **€3,000.00**

## APPENDIX 1. ITINERARY

### 37° SANREMO RALLY STORICO

Leg 1		Friday 14 October 2022						
RS	TC	Location	Km			Target Time	AVS	1st Car
	SS		Liaison	TOT				
1	0	Sanremo - Corso Imperatrice - ( Start )					08:30	
	1	Carpasio		31,47	31,47	01:00	31,5	09:30
2	<b>SS 1</b>	<b>Colle d'Oggia 1</b>	<b>10,74</b>			<b>00:03</b>		<b>09:33</b>
	2	Teglia		3,15	13,89	00:22	37,9	09:55
3	<b>SS 2</b>	<b>Passo Teglia 1</b>	<b>9,17</b>			<b>00:03</b>		<b>09:58</b>
	2A	RSP IN		3,73	12,90	00:18	43,0	10:16
4	<b>A</b>	Remote SERVICE PARK - Molini di Triora	<b>19,91</b>	<b>38,35</b>	<b>58,26</b>	<b>00:15</b>		
	<b>RZ 1</b>	REFUEL ZONE - Molini di Triora	19,15	36,62	55,77	To next RZ		
5	2B	RSP OUT						10:31
	3	Molini di Triora		0,80	0,80	00:06	8,0	10:37
6	<b>SS 3</b>	<b>Langan 1</b>	<b>19,15</b>			<b>00:03</b>		<b>10:40</b>
	3A	R IN		35,82	54,97	01:20	41,2	12:00
7		REGROUP - Sanremo ( Vecchia Stazione)				01:00		
8	3B	R OUT / SP IN						13:00
	<b>B</b>	SERVICE PARK - Sanremo	<b>19,15</b>	<b>36,62</b>	<b>55,77</b>	<b>00:30</b>		
9	3C	SP OUT						13:30
	<b>RZ 2</b>	REFUEL ZONE - Sanremo	19,91	38,35	58,26	To next RZ		
10	4	Carpasio		31,47	31,47	01:00	31,5	14:30
	<b>SS 4</b>	<b>Colle d'Oggia 2</b>	<b>10,74</b>			<b>00:03</b>		<b>14:33</b>
11	5	Teglia		3,15	13,89	00:22	37,9	14:55
	<b>SS 5</b>	<b>Passo Teglia 2</b>	<b>9,17</b>			<b>00:03</b>		<b>14:58</b>
12	5A	RSP IN		3,73	12,90	00:18	43,0	15:16
	<b>C</b>	Remote SERVICE PARK - Molini di Triora	<b>19,91</b>	<b>38,35</b>	<b>58,26</b>	<b>00:15</b>		
13	<b>RZ 3</b>	REFUEL ZONE - Molini di Triora	19,15	36,77	55,92	To next RZ		
	5B	RSP OUT						15:31
14	6	Molini di Triora		-8,37	0,80	00:06	8,0	15:37
	<b>SS 6</b>	<b>Langan 2</b>	<b>19,15</b>			<b>00:03</b>		<b>15:40</b>
15	6A	SP IN		35,97	55,12	01:20	41,3	17:00
	<b>D</b>	SERVICE PARK - Sanremo	<b>19,15</b>	<b>36,77</b>	<b>55,92</b>	<b>00:45</b>		
	6B	SP OUT / PF IN						17:45

1.1 HIS

TOT LEG 1

**78,12 150,09 228,21**

0905

## 37° SANREMO RALLY STORICO

Leg 2		Saturday 15 October 2022						
RS	TC	Location	Km			Target	AVS	1st
	SS		SS	Liaison	TOT	Time		Car
16	6C	PF OUT - SP IN						08:15
	E	SERVICE PARK - Sanremo	0,00	0,00	0,00	00:15		
17	6D	SP OUT						08:30
	RZ 4	REFUEL ZONE - Sanremo	31,77	40,68	72,45	To next RZ		
18	7	Bivio Vignai		22,74	22,74	00:38	35,9	09:08
	SS 7	<i>Vignai 1</i>	14,23			00:03		09:11
19	F	Remote SERVICE ZONE - Bajardo	14,23	8,51	22,74			
	8	Passo Ghimbegna		4,51	18,74	00:32	35,1	09:43
20	SS 8	<i>Bignone 1</i>	10,51			00:03		09:46
	9	S. Romolo		0,83	11,34	00:18	37,8	10:04
21	SS 9	<i>Coldirodi</i>	7,03			00:03		10:07
	9A	R IN		12,60	19,63	00:30	39,3	10:37
21		REGROUP - Sanremo ( Vecchia Stazione)				00:50		
22	9B	R OUT / SP IN						11:27
	I	SERVICE PARK - Sanremo	17,54	32,17	49,71	00:30		
23	9C	SP OUT						11:57
	RZ 5	REFUEL ZONE - Sanremo	32,64	39,80	72,44	To the End		
24	10	Bivio Vignai		22,74	22,74	00:38	35,9	12:35
	SS 10	<i>Vignai 2</i>	14,23			00:03		12:38
25	J	Remote SERVICE ZONE - Bajardo	14,23	8,51	22,74			
	11	Passo Ghimbegna		4,51	18,74	00:32	35,1	13:10
26	SS 11	<i>Orlando Dallava</i>	18,41			00:03		13:13
	11A	SP IN		12,55	30,96	00:50	37,2	14:03
27	K	SERVICE PARK - Sanremo	18,41	31,29	49,70	00:10		
	11B	SP OUT / R IN - ( End )						14:13
27		REGROUP - Sanremo ( Vecchia Stazione)				00:10		
		Sanremo - Corso Imperatrice ( Podium )						14:23

1.1 HIS

TOT LEG 2

64,41	80,48	144,89
-------	-------	--------

0905

	1st Car	n° SS	% SS	Km SS	Km Lia.	Tot Km	Sunrise - Sunset
L1	08h30 - 17h45	6	34,2%	78,12	150,09	228,21	07h42 - 18h46
L2	08h15 - 14h23	5	44,5%	64,41	80,48	144,89	
TOT		11	38,2%	142,53	230,57	373,10	



## **APPENDIX 2. RECONNAISSANCE SCHEDULE**

Each crew is limited to 3 passages on each Special Stage.  
Special Stages run twice are considered to be one Special Stage.

SS11 is considered to be one special stage with SS9 and SS10

### **Wednesday, October 12<sup>th</sup>, 2022**

**Time: 8:00 – 20:00**

SS 1/4

SS 2/5

SS 3/6

### **Thursday, October 13<sup>th</sup>, 2022**

**Time: 8:00 – 13:30**

SS 7/10

SS 8+9/11



### **APPENDIX 3. COMPETITORS' RELATIONS OFFICERS**



**NAME: Franco Peirano**  
**Phone: +39 333 2809898**

**Languages: Eng- Fra - Ita**



**NAME: Pietro Migliori**  
**Phone: +39 348 3510262**

**Languages: Fra-Ita**

**The COMPETITORS' RELATIONS OFFICERS will be identifiable by a red tabard with text CRO.**

**The CROs will be present at the Administrative Checks, Shakedown, Scrutineering, Service Parks, Start/End of Leg 1 and 2, Regrouping areas and Finish.**

**A detailed CROs' Schedule will be posted on the Official Notice Board, on the event website and will also be provided to Competitors during Administrative Checks.**

## APPENDIX 4. COMPETITION NUMBERS AND ADVERTISING

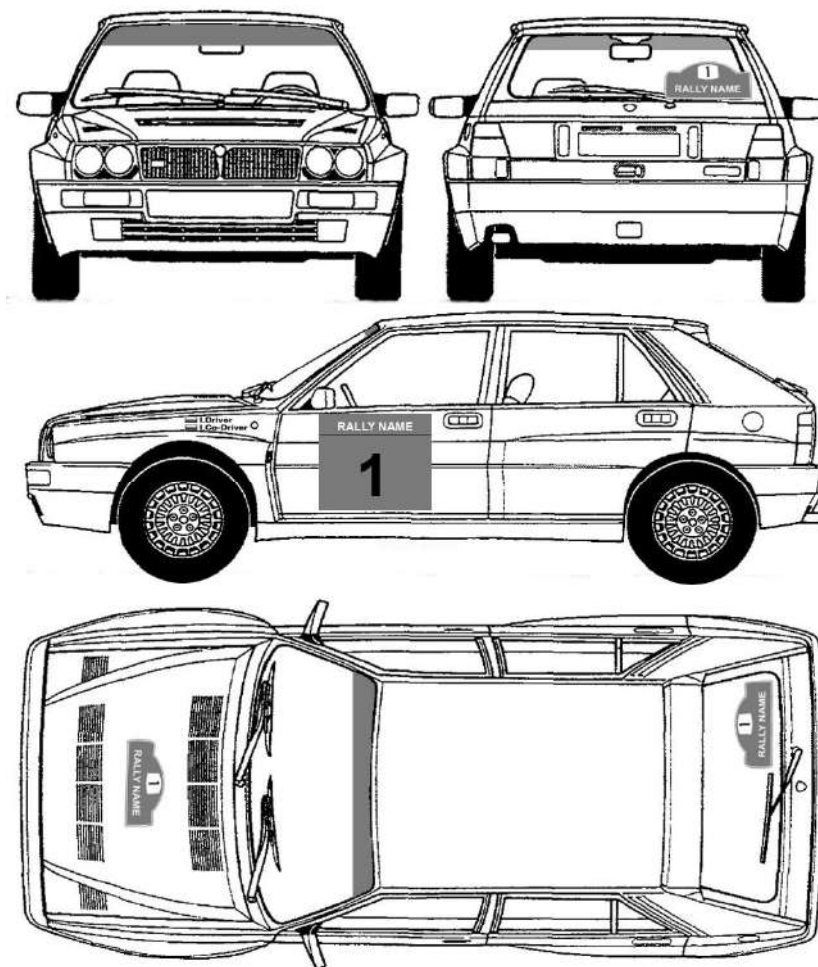

All cars must comply with the Article 2.1.9 of Appendix K.

- **Competition Numbers**

- 1 – door panels (2 per car): 50cm x 52cm height
- 2 – rally plate 43cm x 21,5cm height
- 3 – rear/side windows 28cm x 15cm height

- **Optional Advertising – space reserved for Organiser’s advertising**

[TBA]

- **Driver and Co-Driver Names**

The names of the crew plus their national flags must appear on both sides of the wings at the front of the car (max size 10cm x 40cm). Any car failing to comply with this rule shall be subject to a penalty.

- **Scrutineering Sticker** - 12cm x 10cm height





## APPENDIX 5. EXTRACTS FROM FIA APPENDIX L RELATING TO OVERALLS, HELMETS AND ANY OTHER SAFETY REQUIREMENTS

All competitors are reminded of Appendix L of the FIA International Sporting Code, in particular its Chapter III - Drivers' Equipment.

### **Helmets (Appendix L, Chapter III, Art. 1)**

All crews must wear crash helmets homologated to one of the following FIA standards:

- 8858-2002 or 8858-2010 (Technical List N°41),
- 8859-2015 (Technical List N°49),
- 8860-2004 or 8860-2010 (Technical List N°33), or
- 8860-2018 or 8860-2018-ABP (Technical List N°69)

### **Frontal Head Restraint (FHR, Appendix L, Chapter III, Art. 3)**

All crews must use FIA approved FHR systems homologated to FIA standard 8858.

Approved FHRs, anchorages and tethers are listed in Technical List N° 29.

See also helmet compatibility chart in Appendix L, Chapter III, Art. 3.3.

### **Flame-resistant clothing (Appendix L, Chapter III, Art. 2)**

All drivers and co-drivers must wear overalls as well as gloves (optional for co-drivers), long underwear, a balaclava, socks and shoes homologated to the FIA 8856-2000 standard (Technical List N°27) or 8856-2018 (Technical List N° 74). Please pay special attention to the prescriptions of Art. 2 concerning embroidery and printing on flame-resistant clothing (manufacturer certificates etc.) as well as concerning the correct wearing of the clothing elements! See also Regional Rally Sporting Regulations, Article 53.1.

### **Biometric Devices (Appendix L, Chapter III, Art. 2.1)**

Drivers may wear a device to collect biometric data during racing.

- If the biometric device is integrated into a protective garment homologated to FIA Standard 8856, the garment shall be homologated to FIA Standards 8856 and 8868-2018.
- If the biometric device is a stand-alone device, then the device must be homologated to FIA Standard 8868-2018 only. This device must be worn in addition to the garment homologated to FIA Standard 8856.

### **Wearing of jewellery (Appendix L, Chapter III, Art. 5)**

The wearing of jewellery in the form of body piercing or metal neck chains is prohibited during the competition and may therefore be checked before the start.

#### **RELATED LINKS:**

FIA International Sporting Code and appendices:

<https://www.fia.com/regulation/category/123>

FIA Technical Lists:

<https://www.fia.com/regulation/category/761>

## APPENDIX 6. SAFETY TRACKING SYSTEM INSTRUCTIONS



### TRACKING SYSTEM SERVICE

#### Presentation – Informative 2018

The GPS Tracking System RDS is a GPS / GSM communication system by which all competitors of a rally are monitored along the route of the special stages and transfers. Data from GPS devices installed on your vehicle are transmitted to the RDS server and made available to the Race Direction for the purpose of monitoring the race for safety reasons and sports. The GPS tracking system is mandatory for all Rally events (please read Regulation ACI Sport Service).

#### The system Tracking System GPS RDS consists of two devices:



##### Rally KIT

(purchased and installed by the crew)



##### BOX GPS

(owned by RDS)

The "Rally KIT" consists of a box with a **SOS** request button, **OK** button, spies monitoring supply and wiring connection to the Battery, the IGNITION and "GPS BOX" RDS.

The crew will purchase it and install it on the car in a stable and permanent way according to the preferences of the pilot and the navigator, but, in all cases, according to criteria set by ACI Sport Service. Among the most important indications: *the SOS request button must be accessible from both members of the crew and with seat belt.*

For the installation, see the documentation provided with the kit.

Before any race, the RDS technical staff will connect your "GPS BOX" with the "Rally KIT".

At the end of the race the "GPS BOX" will be uninstalled and disconnected from the "Rally KIT".

**ATTENTION.** Both the GPS BOX and the Rally KIT are provided with **SOS** button. It is reminded that this key must be used exclusively for a possible request for RESCUE. Pressing the SOS button, the Race Direction will be promptly informed about the emergency.

In the GPS BOX there is also the **OK** button to indicate that "at the present there are no alarms or warnings". It must be pressed for at least 3 seconds.

## Installation and Positioning

### Installing the Rally KIT predisposition.

The Rally KIT will be installed by the owner of the vehicle, following the wiring diagram in the package (or they can be downloaded from the site [www.rdsitalia.it](http://www.rdsitalia.it)).

In the Rally KIT there is the SOS request button.

The SOS button of the Rally KIT must be easily accessible from both members of the crew with seat belt.



The connector for the GPS BOX (coloured black-blue, in the Rally KIT) has to reach the upper-central area of the dashboard or, alternatively, the right front roll bar so as to be easily connectable to the GPS BOX.

### Installing the GPS BOX.

The BOX GPS will be installed by the staff of Tracking System during the pre-event checking.

Also in this device there is a SOS button and it performs the same function as the one placed in the Rally KIT.

It must be placed under the windshield so as to ensure the proper functioning of the GPS survey ("sky view"). For safety reasons, any other position is not allowed.

It will be positioned on the upper-central part of the dashboard or, alternatively, on the right front roll bar.

The alternative location (roll front right) is to be preferred if and only if the pilot believes that the lights of the SOS buttons and OK disturb driving during the race.

It will be returned to staff only after the race.



**IMPORTANT:** Under no circumstances it is allowed to tamper with both "Rally KIT" and "GPS BOX". The Competitor and the Organizer agree not to tamper with, intervene, remove and / or physically compromise these devices and their functionality.

Any interference or alteration will cause the reporting of the competitor to the Stewards or the Single Judge for the measures that will be considered most appropriate.

Each technical issue and observation must be addressed to the supplier of the product.



#### What will the crew have to pay?

- The payment of the Tracking System service is included, unless otherwise noted, in the entry fee to the event.
- The **Rally KIT** will be bought only once and will be owned by the buyer. The price is **€ 61.00** (€ 50.00 + VAT). The buyer can request an invoice by connecting to our web page: <http://www.rdsitalia.it/rich-fatt.html>
- For cars from abroad, performing occasionally races in Italy, there is no obligation to purchase the **KIT Rally**. In these cases the **KIT Rally** will be hired for the price of € 15,00. The **KIT Rally** will be returned to RDS only after the race along with the GPS BOX.
- In any event, during the sport checks, it is also required a payment of **€ 150.00** as deposit (or a document), which will be returned after the race at the time of the withdrawal of the GPS BOX and upon presentation of the receipt issued at the time of payment. Any GPS BOX that, due to majeure force, will not be returned or collected after the race, must be sent to the RDS Srl company via courier and expenses borne by the applicant, within 3 days.  
Upon receiving the GPS BOX, the deposit will be given to the competitor.

#### Service subscription - Privacy

By subscribing to the event you will automatically accept the privacy legislation linked to the service Tracking System.

The data collected will be used to carry out properly the service of tracking during the race to which we are about to participate.

#### Assistance during demonstrations

Unless otherwise indicated, the RDS personnel will be present to the Service Park, to provide assistance to all the crews, treat the return of the trackers and return the deposits previously paid by the crews. However, it is not excluded that the return will take place at the RDS station in Race Direction or other place / environment. This will depend on the location of the areas and how the event is organized.

In the hope that this document has been helpful and has cleared any doubts, RDS gives all riders a sincere "good luck" and have fun.

RDS s.r.l.

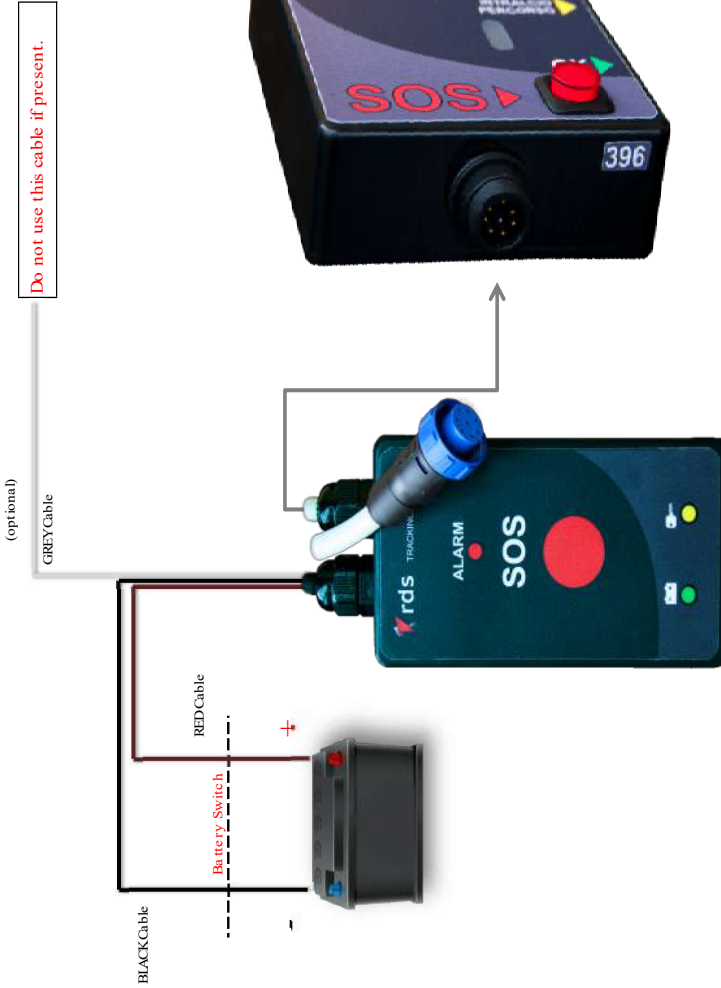

Do not use this cable if present.

(optional)  
GREY Cable

### KIT Rally preparation

Many customers, in order to rapidly prepare the assembly Rally kit, asked information about the installation even before receiving the material. We hope you appreciate our anticipation of some simple instructions on how to perform the installation. The complete and detailed instruction is inside the packaging.

### INSTALLATION

The assembly of the kit is quite simple. Just connect:  
\* A cable to the negative of the battery;  
\* A cable to the positive of the battery;

**IMPORTANT: Connect all under the battery switch.**

NB: It is not necessary to provide safety fuses. They are already present in the KIT and easily accessible.

The gray line in the diagram represents the connection cable to the GPS BOX RDS that will be installed and uninstalled at every race.

This cable, therefore, must not be connected to anything. Only made available and well in sight, so that the staff RDS can perform the installation and activation of the tracking system in the shortest time possible.



## APPENDIX 7. FLAGS USED DURING THE RALLY

For signals to crews, yellow and red signalling Flags will be used according to Italian sporting rules, with the following meanings:

### **Red flag**

Will be shown waved only on instruction from the Clerk of the Course in intermediate posts when it becomes necessary to stop the special stage; all Drivers must reduce speed and follow marshals' instructions.

### **Yellow flag**

Will be shown waved as signal of danger at the marshal post preceding the hazard; all Drivers must reduce speed and be prepared to change direction.



## APPENDIX 8. CARS OR CREWS NOT COMPLIANT TO FIA REGULATIONS

Cars or crews not in compliance with FIA regulations, but totally compliant to Italian RDS CIRAS can participate to 37° Rallye Sanremo Storico; they will start after the last FIA compliant crew, with a distinctive gap of time.

The SR of FIA EHRC rally will be used to rule also the race of these crews except for:

- They will not be included in 80 maximum starters for FIA EHRC Rally
- They will not be included in FIA Rally classifications or documents.
- They will start among FIA EHRC in a single starting list
- Cars will be classified following Italian RDS CIRAS
- Entry must be filled in, following Italian RDS, on [www.acisport.it](http://www.acisport.it) , before October 5<sup>th</sup>, 2022 - Crews entered in FIA EHRC rally found at administrative checks or scrutineering not in compliance to FIA regulations but in compliance to Italian RDS CIRAS will also be admitted and their starting order will be updated accordingly.